

Project	
Date	
Prepared By	
Model #	MP02900407WH2

## Specifications

### ELECTRICAL

**Watts:** 15  
**Voltage:** 120VAC  
**Power Factor:** 0.95  
**Operating Temp. Range:**  
 -40°F to 135°F

### LIGHT

**Initial Lumens:** 900  
**Lumens per Watt:** 60  
**Color Temperature:** 4000K  
**CRI:** 92  
**Dimmable:** Yes

### AGENCY APPROVALS

**Energy Star:** Yes  
**ETL:** Yes  
**FCC:** Yes

### PRODUCT DETAILS

**Lens:** Acrylic  
**Warranty:** 5 years  
**Fixture**  
**Rated Life:** 50,000 hours  
**Weight:** 1.01 LBS  
**Dimensions:**  
 7.17"D x 1.65"M

# LED 7" Panel Light

900 Lumens, 15 Watt, 4000K

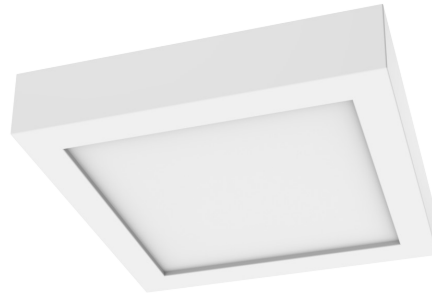

### ORDER CODE:

MP02900407WH2

### MODEL NUMBER:

MP02900407WH2

### ENERGY STAR PRODUCT ID:

2320473

### REBATE AVAILABILITY\*

## PRODUCT DESCRIPTION

The 7" LED Panel light is constructed using attractive impact resistant acrylic lens that helps achieve a wide light distribution pattern. These Panel lights are ideal for use in residential, offices, schools, healthcare, and many other commercial applications.

Designed for easy installation in retrofit or new construction projects. Energy Star rated. This 15 watt panel light produces 900 lumens of 4000K high >90CRI light quality. Operates on 120VAC 60Hz and is compatible with standard incandescent dimmer controls providing a 100% to 5% dimming range. Easily installs on 4" j-boxes. Also can be used as a retrofit for 4" downlight recessed fixtures with an available accessory kit. Not for use in outdoor locations.

## PRODUCT FEATURES

- + Easily installs on 4" j-box
- + 900 lumens, 4000K
- + Exceptional color rendering CRI >90
- + Smooth edgelit LED technology
- + Wet location rated, perfect for shower applications
- + 4" recessed can accessory kit available
- + Not for use in outdoor locations
- + 50,000 hour rated life

## APPLICATIONS

- + Closets
- + Hallways
- + Stairways
- + Storage Areas
- + Basements
- + Bathrooms
- + Entryways
- + Showers
- + Commercial Lighting

Please consult installation instructions for proper application and use of this fixture.  
 \*Rebate availability access it here: [www.earthtronics.com/rebate-finder](http://www.earthtronics.com/rebate-finder)

## PRODUCT DIMENSIONS

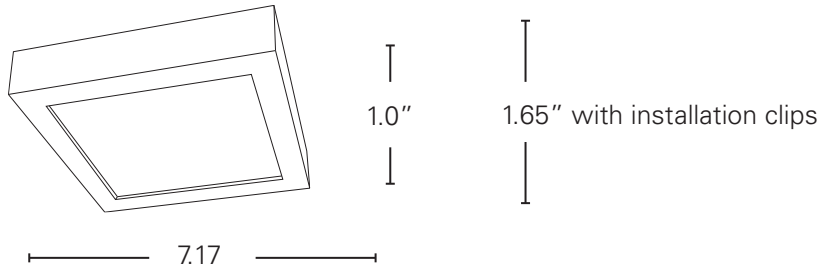

## PACKAGE DETAILS

### INDIVIDUAL PACKAGE

Individual Carton Qty: 1

**Dimensions:**

7.28" Length x 2.44" Width x 7.48" Height

**Weight:** 1.2408 LBS

**UPC:** 840791109267

### MASTER CARTON

Master Carton Qty: 20

**Dimensions:**

15.43" Length x 13.42" Width x 16.77" Height

**Weight:** 24.82 LBS

**UPC:** 84079110926700

## INSTALLATION

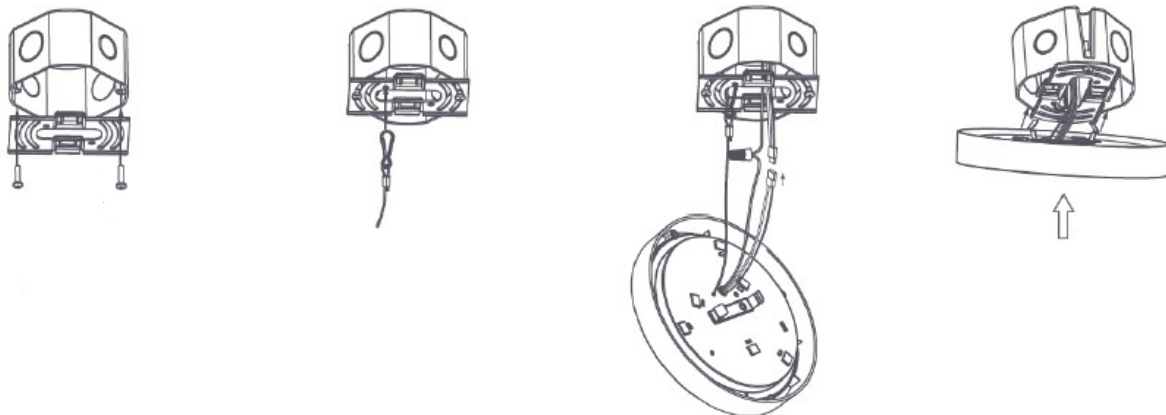

Easily access our Energy Star listed products with rebates in your area.

**ACCESS IT HERE:** [Rebate Finder - LED Mini Panel](#)

[www.earthtronics.com/rebate-finder/catalog/](http://www.earthtronics.com/rebate-finder/catalog/)

